

**4K UHD**

# 4K VIDEO WALL SOLUTIONS

ORION Images R4N (UHD) Video Wall series has Immediate Benefits for Security Room, Retail, Shopping Mall, Corporation, Broadcast, Transportation, Government, Health Care, Casino and more

**LED**  
**R4N65UHU** **NEW**



The R4N (UHD) Series of LCD Displays is the perfect solution for ultra-high definition video walls. Equipped with 3840 x 2160 resolution panel and the ability to take a single video source and displaying across the entire Video Wall; it is an excellent choice for command & control centers, corporate, AV and digital signage applications.

|                                       |                               |   |                |                               |                       |               |               |                         |
|---------------------------------------|-------------------------------|---|----------------|-------------------------------|-----------------------|---------------|---------------|-------------------------|
| <b>2.5mm<br/>1.2mm</b><br>Bezel Width | <b>4K</b><br>Input Resolution | <b>700<br/>cd/m<sup>2</sup></b><br>Max Brightness | <br>Mobile App | <b>HDMI</b><br>HDMI Input 3ea | <br>DP Input / Output | <br>DVI Input | <br>VGA Input | <br>RS-232 Input/Output |
|---------------------------------------|-------------------------------|---|----------------|-------------------------------|-----------------------|---------------|---------------|-------------------------|

## Video Walls for Security, Control Rooms, Commercial AV, Professional AV & has immediate benefits for:

In addition, this solution can also be used for corporate AV and Digital Signage applications such as shopping malls, airports, stadiums, lobby signage, boardrooms, and more. Whether small lobby display or extra large video walls, the tiled R4N series makes statement. Public Display Signage receives 10 times the eye contact of static signage and is creating cost-effective opportunities to improve customer service, safety, way finding, branding, training, and communications.

Unlike plasma technology, LCD video walls require less power consumption and with auto pixel shift built in they are not subject to permanent, irreversible burn-in. Unlike individual mount LCD's that leave gaps between each monitor, tiled video walls offer more flexibility, scalability and the possibility for a higher resolution.

**ULTRA NARROW BEZEL**

R4N65UHU: Top & Bottom Side Bezel is 3.7mm, Left & Right Side Bezel is 3.7mm

- » Security / Control Rooms
- » Retail
- » Universities & colleges
- » Corporations
- » Transportation
- » Health Care & Medical
- » Government
- » Financial Institutions
- » Hospitality
- » Casino

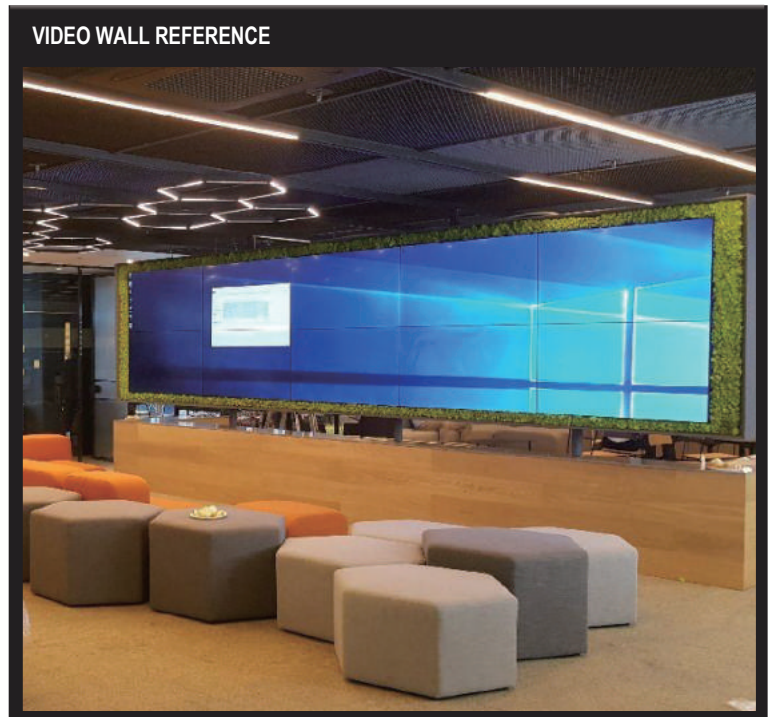

## SPECIFICATIONS

| R4N65UHU                             |   |
|--------------------------------------|---|
| <b>Bezel Width</b>                   |   |
| Bezel Width                          | 2.5mm / 1.2mm                                       |
| <b>Display</b>                       |   |
| Screen Size                          | 64.53 Inch  |
| Max. Resolution                      | 3840 x 2160 @ 60Hz                                  |
| Pixel Pitch                          | 0.372 x 0.372mm                                     |
| Brightness                           | 700cd/m <sup>2</sup>                                |
| Contrast Ratio                       | 4000 : 1  |
| Aspect Ratio                         | 16 : 9  |
| Viewing Angle                        | 178° / 178°   |
| Display Color                        | 16.7 Million (8bit)                                 |
| Response Time                        | < 8ms (Gray to Gray BW)                             |
| <b>Interface</b>                     |   |
| Display Port In/ Out                 | 1 / 1   |
| HDMI Input                           | 3   |
| DVI In                               | 1   |
| VGA In                               | 1   |
| RS232 In / Out                       | 1 / 1   |
| Audio Out (3.5 Ø stereo)             | 1   |
| <b>Transmitter</b>                   |   |
| IR Remote Control                    | Yes   |
| <b>Features</b>                      |   |
| Multi Display Function               | PBP / PIP / QUAD                                    |
| Temperature Sensor                   | Yes (Option)  |
| De-Interlace                         | Yes   |
| Noise Reduction                      | Yes   |
| Auto Fan Control System              | Yes (Option)  |
| Auto Pixel Shift                     | Yes   |
| Auto Source Switching                | Yes   |
| Edge Setting (Horizontal / Vertical) | Yes   |
| Advance Auto Power Recovery          | Yes   |
| Language                             | English   |
| RS-232C Control                      | Monitor OSD control                                 |
| <b>Outline Dimension</b>             |   |
| Dimension (W x H x D)                | 1432.58 x 807.62 x 90.5 mm (56.4" x 31.79" x 3.56") |
| Net. Weight                          | 40Kg (88.18 lbs)                                    |
| <b>Warranty</b>                      |   |
| Part / Labor                         | 1year / 1year                                       |
| <b>Circumstance</b>                  |   |
| Operating Temperature                | 0° ~ 40° C / 32° ~ 104° F                           |
| <b>Power</b>                         |   |
| Electrical Ratings                   | AC 100 ~ 240V (50/60Hz)                             |
| <b>Mount</b>                         |   |
| VESA™ Mount Size                     | 600 x 400mm   |

\* Specifications and design are subject to change without notice.

## HARDWARE

### Hardware features:

- » Spread 1 image across multiple monitors using 1 video source
- » Video Wall Processor built in
- » Remote Display Management (IR Remote or Mobile WIFI)
- » Display Port 1 In / 1 Out
- » HDMI 3 In / VGA In / DVI In
- » RS-232C In / Out for pc / server control
- » Control panel Lock (panel or IR)
- » All metal chassis
- » Auto power recovery
- » Auto pixel shift
- » PIP / PBP / QUAD Displays
- » VESA standard hole patterns

## INTERFACE

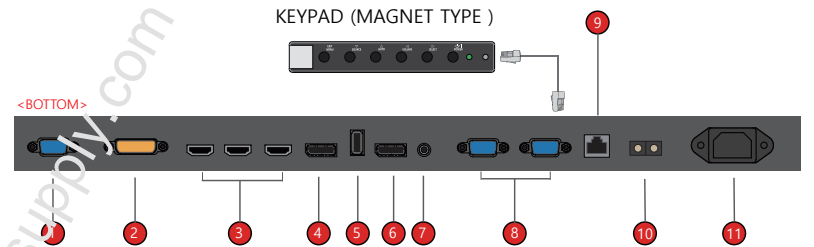

<BOTTOM>

- 1 **VGA** : VGA signal Input
- 2 **DVI** : DVI signal Input
- 3 **HDMI1~3** : HDMI1~3 Input
- 4 **DP** : DP signal Input
- 5 **USB** : FW Update Input
- 6 **DP** : DP signal Output
- 7 **Audio** : Audio Line Output
- 8 **RS-232** : RS-232 Control Input / Output
- 9 **Keypad** : UTP cable Input for Keypad
- 10 **Rotary Switch** : Setting Set ID
- 11 **AC Power** : AC Power Input

## DIMENSION

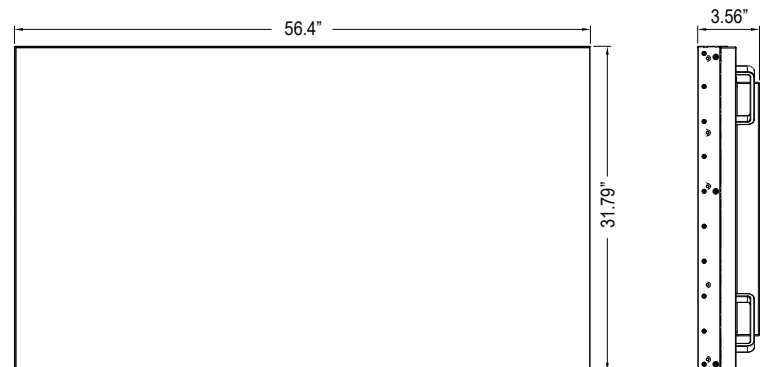
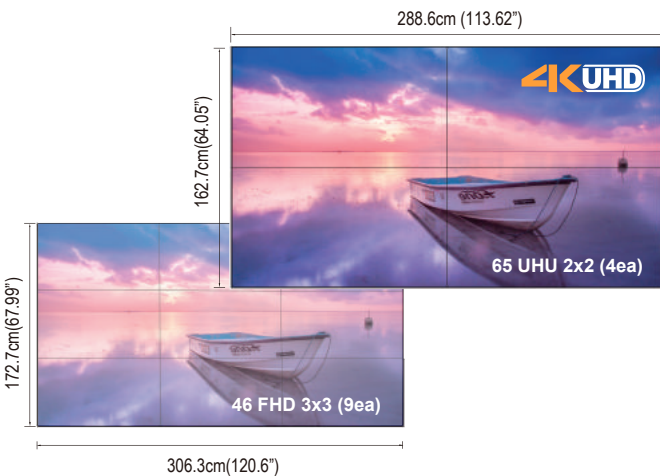

\*Design and specifications are subject to change without notice