

FUJIFILM
expect INNOVATION™

ZA SELECT



ZA17x7.6BE RM/RD

Technology That Inspires...

FUJINON

AUDIOVIDEO SUPPLY

For design help, accessories or pricing, please contact:
sales@avsupply or call: 1-858-565-1101

1-800-284-2288 sales@avsupply.com
www.avsupply.com

Distributed By: Audio Video Supply -- Tel: 1-800-284-2288 -- www.avsupply.com

ZA17x7.6BE RM/RD*



LENS	ZA17x7.6BE RM/RD*
Zoom Ratio / Format	17X / 2/3"
Focal Length	7.6 to 130 mm
Extender	(2X) 15.2 to 260 mm
Maximum Relative Aperture	1:1.8 (7.6 ~ 102 mm)
Aperture	1:2.3 (130 mm)
Maximum Photometric Aperture T-No.	1:1.9 (7.6 ~ 102 mm)
Aperture T-No.	1:2.5 (130 mm)
Angular Field of View	7.6 mm64° 30' x 39° 03'
16:9 Aspect Ratio	130 mm4° 13' x 2° 23'
	(2X)15.2 mm35° 01' x 20° 07'
	260 mm 2° 07' x 1° 11'
M.O.D. from Image Plane	0.84 m
M.O.D. from Front of Lens	0.6 m
Object Dimensions at M.O.D.	7.6 mm 696 x 392 mm
	130 mm 43 x 24 mm
	(2X) 15.2 mm 384 x 196 mm
	260 mm 21 x 12 mm
Filter Size	ø 82 mm P=0.75 (On Barrel)
Dia ø x Length (w/o Hood)	ø85 x 203 mm
Weight (w/o Hood)	1.53 kg (RM) / 1.6 kg (RD)*
Options	16 Bit Encoder
Features	Inner Focus / Zoom Limit Quick Zoom

*RD contain servo for zoom and focus.

ACCESSORIES: HD & SD ENG/EFP

THREE-MODE FINE FOCUS

By shifting the sensitivity from the wide side to the telephoto side of the focus range, this control provides more precise focusing for studio or sports productions.

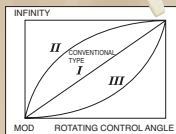

SERIAL DIGITAL REMOTE CONTROL BY PC

Remote control of zoom, focus and iris for Digipower lenses is possible via serial digital link, providing accurate positioning for virtual studio and other applications requiring digital precision.

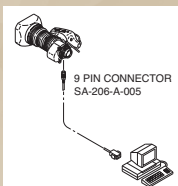

DIGI POWER REAR CONTROL KITS

MS-11D Manual Focus/Servo Zoom

For use with RM/ZM type lenses.

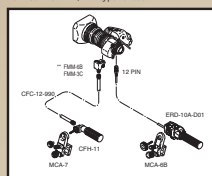

SS-11D Servo Focus/Servo Zoom

For use with RM/ZM type lenses.

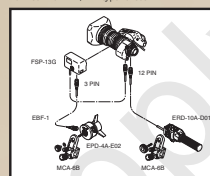

SS-13D Servo Focus/Servo Zoom

For use with RD/ZD type lenses.

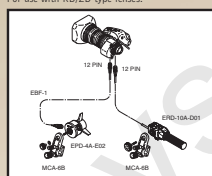

SS-14S Servo Focus/Servo Zoom

For use with RD/ZD type lenses.

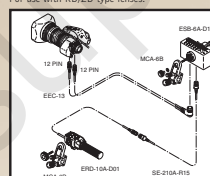

STANDARD REAR CONTROL KITS

MS-11 Manual Focus/Servo Zoom

For use with RD/ZD type lenses.

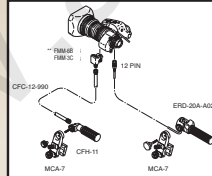

SS-11 Servo Focus/Servo Zoom

Not available on HA42x, HA36x and A36x

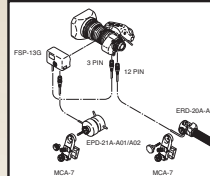

SS-13A Servo Focus/Servo Zoom

For use with ERD type lenses.

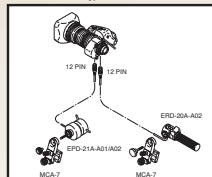

MM-11 Manual Focus/Manual Zoom

Not available on HA42x, HA36x and A36x

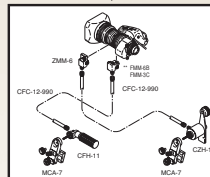

*Specify camera type

**FMM-3C for use on HA36x, HA42x and HA25x

MOUNTING SYSTEM

Fujinon has replaced the "cone" shaped mounting system with the "tooth" system. The cone type may still be ordered as a special order.



ACCESSORIES: HD ENG/EFP

LENS CONVERTERS



HD/ENG LENS CONVERTERS

Model	Type	ø Size	Converter*	Mag.	Converted Focal Length (mm)	M.O.D. (m)	Weight (kg)
HS16x4.6	TELE	95 mm	TCV-H95	1.5x	74.0→111.0	0.90	1.0
	WIDE	95 mm	WCV-H95	0.8x	4.6→3.9	0.29	1.0
HS18x5.5/ HS18x5.5	TELE	85 mm	TCV-H85	1.5x	100.0→150.0	1.35	1.1
	WIDE	85 mm	WCV-H85	0.8x	5.5→4.4	0.38	1.0
	WIDE	85 mm	FATH85	0.7x	5.5→3.9	0.29	0.3
	FISHEYE	85 mm	F-ATH85	0.57x	5.5→3.1	0.19	0.3
HA16x6.3	TELE	95 mm	TCV-H95	1.5x	101.0→152.0	0.90	1.0
	WIDE	95 mm	WCV-H95	0.8x	6.3→5.4	0.29	1.0
HA18x7.6E/ HA18x7.6	TELE	85 mm	TCV-H85	1.5x	137.0→205.5	1.35	1.1
	WIDE	85 mm	WCV-H85	0.8x	7.6→6.1	0.38	1.0
	WIDE	85 mm	FATH85	0.7x	7.6→5.3	0.39	0.5
	FISHEYE	85 mm	F-ATH85	0.57x	7.6→4.3	0.26	0.6
HA22x7.3E	TELE	110 mm	TCV-H110	1.5x	161.0→242.0	1.90	1.1
	TELE	100 mm	TCV-H100	1.5x	175.0→262.5	1.80	1.0
HA23x7.6E	WIDE	100 mm	WCV-H100	0.8x	7.6→6.1	0.51	1.0
	WIDE	100 mm	FATH100	0.7x	7.6→5.3	0.39	0.5
	WIDE	100 mm	F-ATH100	0.57x	7.6→4.3	0.26	0.6
	TELE	100 mm	TCV-H100	1.5x	94.0→141.0	1.35	1.1
XS17x5.5	WIDE	85 mm	WCV-H85	0.8x	5.5→4.4	0.38	1.0
	WIDE	85 mm	FATH85	0.7x	5.5→3.8	0.29	0.3
	FISHEYE	85 mm	F-ATH85	0.57x	5.5→3.1	0.19	0.3
ZA17x7.6	TELE	85 mm	TCV-H85	1.5x	130.0→195.0	1.35	1.1
	WIDE	85 mm	WCV-H85	0.8x	7.6→6.1	0.38	1.0
	WIDE	85 mm	FATH85	0.7x	7.6→5.3	0.29	0.3
ZA22x7.6	TELE	100 mm	TCV-H100	1.5x	167.0→250.5	1.80	1.0
	WIDE	100 mm	WCV-H100	0.8x	7.6→6.1	0.51	1.0
	WIDE	100 mm	FATH100	0.7x	7.6→5.3	0.39	0.5
	FISHEYE	100 mm	F-ATH100	0.57x	7.6→4.3	0.26	0.6

*TCV/WCV are zoom thru type **ø 95mm P-1 screw on type
Wide attachment and fisheye attachment can be used at WIDE END.
Number of M.O.D. is at wide end.

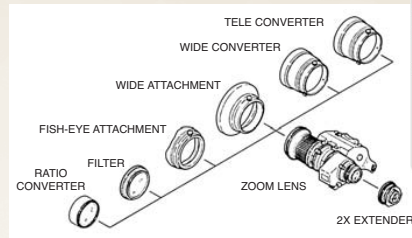

- A. CFC-990 Flex Cable
- B. FMM-3B/6B Manual Module
- C. ZMM-6 Manual Module
- D. EBF-1 Focus Cable
- E. MCA-6
- F. ERD-20A-A02 Zoom Demand
- G. FSP-13G Focus Positional Module
- H. EPD-4A-E02
- I. CZH-14 Focus Handle
- J. CFH-11 Focus Handle
- K. MCA-7 Mounting Clamp
- L. EPD-20A-A01/A02 Focus Demand
- M. ERD-10A-D01 Zoom Demand
- N. ALH-117A-02A Support for HA36x/A36x HA42x



Note: ERD-20A-A02 (F) and EPD-20A-A02 (L) replace the ERD-T22 and EPD-2CA.

For Sales Contact Information go to www.Fujinon.com

For design help, accessories or pricing, please contact: sales@avsupply.com or call: 1-858-565-1101

Distributed By: Audio Video Supply -- Tel: 1-800-284-2288 -- www.avsupply.com